

Crosby[®] Forged Chain Shackles

SCREW PIN

Load Rated



ROUND PIN



G-210 S-210

Screw pin chain shackles meet the requirements of Federal Specification RR-C-271D, Type IVB, Grade A, Class 2.

- Working Load Limit permanently shown on every shackle.
- Forged — Quenched and Tempered, with alloy pins.
- Capacities 1/3 thru 55 tons.
- Look for the red pin . . . the mark of genuine Crosby quality.
- Shackles can be furnished proof tested with certificates to designated standards, such as ABS, DNV, Lloyds, or other certification. Charges for proof testing and certification available when requested at the time of order.
- Hot Dip galvanized or Self Colored.
- Fatigue rated.



G-215 S-215

Round pin chain shackles meet the requirements of Federal Specification RR-C-271D Type IVB, Grade A, Class 1.

Nominal Shackle Size (in.)	Working Load Limit* (tons)	Stock No.				Weight Each (lbs.)	
		G-210 Galv.	S-210 S.C.	G-215 Galv.	S-215 S.C.	G-210 S-210	G-215 S-215
1/4	1/2	1019150	1019169	1018810	1018829	.11	.10
5/16	3/4	1019178	1019187	1018838	1018847	.17	.18
3/8	1	1019196	1019203	1018856	1018865	.24	.25
7/16	1 1/2	1019212	1019221	1018874	1018883	.40	.38
1/2	2	1019230	1019249	1018892	1018909	.59	.50
5/8	3 1/4	1019258	1019267	1018918	1018927	1.21	1.21
3/4	4 3/4	1019276	1019285	1018936	1018945	2.25	2.00
7/8	6 1/2	1019294	1019301	1018954	1018963	3.16	3.28
1	8 1/2	1019310	1019329	1018972	1018981	4.75	4.75
1 1/8	9 1/2	1019338	1019347	1018990	1019007	6.75	6.30
1 1/4	12	1019356	1019365	1019016	1019025	9.06	9.00
1 3/8	13 1/2	1019374	1019383	1019034	1019043	11.63	12.00
1 1/2	17	1019392	1019409	1019052	1019061	15.95	16.15
1 3/4	25	1019418	1019427	1019070	1019089	26.75	29.96
2	35	1019436	1019445	1019098	1019105	42.31	43.25
2 1/2	†55	1019454	1019463	—	—	71.75	—

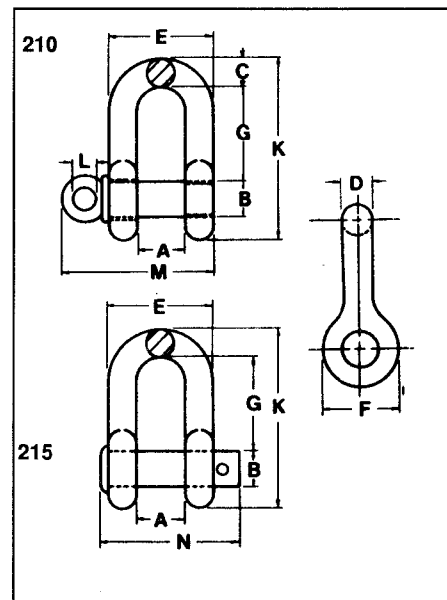

Nominal Size (in.)	Working Load Limit* (tons)	Dimensions (in.)											Tolerance	
		A	B	C	D	E	F	G	K	L	M	N	G	A
1/4	1/2	.47	.31	.25	.25	.97	.61	.88	1.59	.19	1.38	1.34	.06	.06
5/16	3/4	.53	.38	.31	.31	1.16	.75	1.03	1.91	.22	1.66	1.59	.06	.06
3/8	1	.66	.44	.38	.38	1.41	.91	1.25	2.30	.25	2.03	1.86	.13	.06
7/16	1 1/2	.75	.50	.44	.44	1.63	1.06	1.44	2.66	.31	2.38	2.13	.13	.06
1/2	2	.81	.63	.50	.50	1.81	1.19	1.63	3.03	.38	2.69	2.38	.13	.06
5/8	3 1/4	1.06	.75	.62	.63	2.31	1.50	2.00	3.75	.44	3.34	2.91	.13	.06
3/4	4 3/4	1.25	.88	.81	.75	2.75	1.81	2.38	4.53	.50	3.97	3.44	.25	.06
7/8	6 1/2	1.44	1.00	.97	.88	3.19	2.09	2.81	5.33	.50	4.50	3.81	.25	.06
1	8 1/2	1.69	1.13	1.00	1.00	3.69	2.38	3.19	5.94	.56	5.07	4.53	.25	.06
1 1/8	9 1/2	1.81	1.25	1.25	1.13	4.06	2.69	3.58	6.78	.63	5.59	5.13	.25	.06
1 1/4	12	2.03	1.38	1.38	1.25	4.53	3.00	3.94	7.50	.69	6.16	5.50	.25	.13
1 3/8	13 1/2	2.25	1.50	1.50	1.38	5.00	3.31	4.38	8.28	.75	6.84	6.13	.25	.13
1 1/2	17	2.38	1.63	1.62	1.50	5.38	3.62	4.81	9.06	.81	7.35	6.50	.25	.13
1 3/4	25	2.88	2.00	2.12	1.75	6.38	4.19	5.75	10.97	1.00	9.08	7.75	.25	.13
2	35	3.25	2.25	2.00	2.00	7.25	4.81	6.75	12.28	1.22	10.34	8.75	.25	.13
2 1/2	†55	4.13	2.75	2.62	2.62	9.38	5.69	8.00	14.84	1.38	13.00	—	.25	.25

† Furnished in Screw Pin Only.